

# MA 30 Ex ia tD II CT6 24 DC



When this solenoid system is used in combination with „ATEX certified“ mechanical components conforming EN 13463-1:2001 and PrEN 13463-5:2000, the entire valve can be used in explosive hazardous environment zone 1, 2, 21, and 22.

ATEX approved intrinsic safety coil and connector for gas and dust explosion-hazardous environment. System is also IEC-Ex approved. Electrical connection according to DIN EN 175301-803-A / ISO 4400.

**Coil:**

Electrical characteristics: 21,6... 28 V DC  
>37 mA  
final temperature rise  
18 K  
275 Ohm +/-8 %

Relative duty cycle: 100 %

Temperature range: -40° ... +50° C

Insulation class of insulating materials according to DIN VDE 0580: F

Protection level with connector according to EN 60529: IP 65

Moulding material: Thermoset resin (Epoxy)

Marking on coil: II 2G Ex ia IIB/IIC T6  
II 2D Ex tb IIIC T80°C

**Barrier:**

Electrical characteristics: 21,6... 28 V DC  
Admissible peak value: 28 V DC  
115 mA  
1,6 W

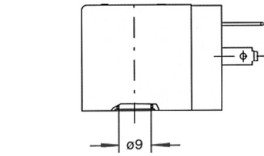

Electrical connection  
DIN EN 175301-803A/ISO 4400

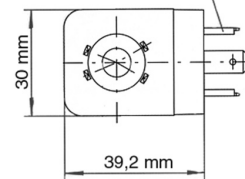

**MA 30 Ex ia tD II CT6 24 DC**

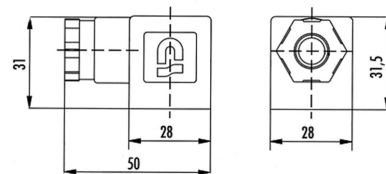

**ST 30 Ex ia**

**Order Code: MA 30 Ex ia tD II CT6 24 DC**

As the coil is 30 mm wide, a spacer plate called „ZPN 5“ has to be used, in case of combination with our NAMUR-valve series 700 refer to page 2.10.12.

ST 30 Ex ia is an ATEX approved connector, especially designed for being used in combination with the intrinsic safety coil. For dust approval (zone 21), this original connector is mandatory. Delivery includes connector ST 30 Ex ia, flat nitril gasket and fixing screw (zinc-plated steel). Form according to A - ISO 4400, no LED, no varistor, operating voltage 0 – 250 V, max. current 10 A, cable diameter 6 – 8 mm.

**How to select a suitable barrier:**  
**I/U Characteristics supply units/solenoid coil**

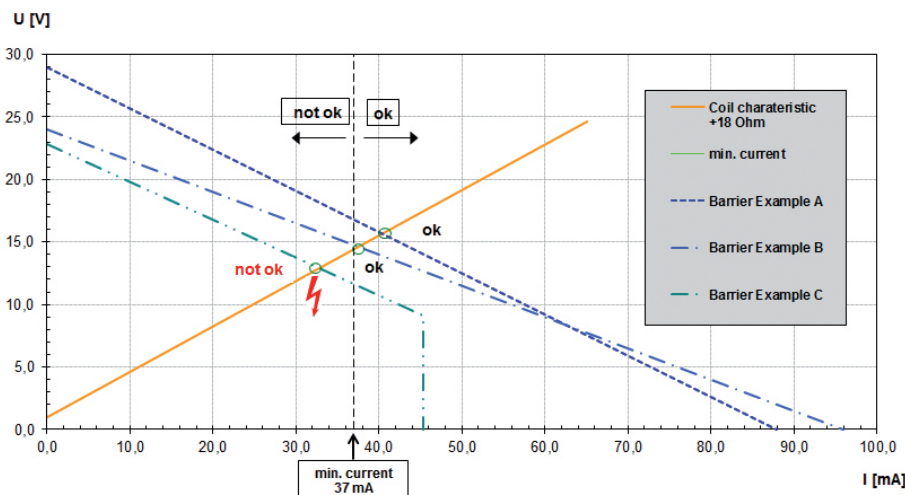

The ATEX approval is only valid as long as the associated components are used.