

# R \_ \_



Common connection to port 1 (pressure).

The following valves can be assembled to the manifold plate type R \_ \_:

- MH 312 port 2: M5
- MH 314 port 2: pif 4 mm
- MH 315 port 2: G 1/8"
- MH 316 port 2: pif 6 mm

All the valves are displayed on page 2.5.1.2.2.

Blanking plates are also available type BP 3.

*All the manifold plates offered by Hafner-Pneumatik can be equipped with the DIN-rail mounting clips.*

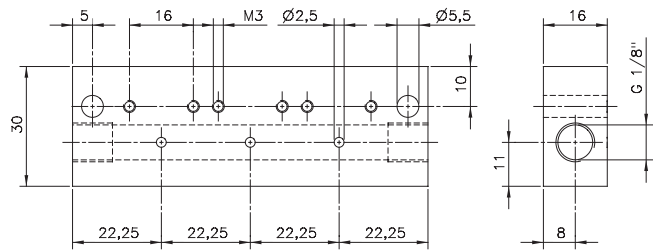

R \_ \_ Orifice size: 8,5 mm

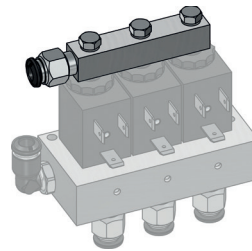

Exhaust rail - RS 03

Available on request:

Exhaust rail to collect the exhausting air at the operator tube. Please ask for our type RS \_ \_ . Please add two digits for the number of positions required. Push-in fitting not included.

Stations	Type	Weight	Availability
1	R 01	0,05 kg	from stock
2	R 02	0,08 kg	from stock
3	R 03	0,11 kg	from stock
4	R 04	0,13 kg	from stock
5	R 05	0,16 kg	from stock
6	R 06	0,19 kg	from stock
7	R 07	0,21 kg	from stock
8	R 08	0,24 kg	from stock
9	R 09	0,27 kg	from stock
10	R 10	0,30 kg	from stock
11	R 11	0,32 kg	from stock
12	R 12	0,35 kg	from stock
13	R 13	0,38 kg	from stock
14	R 14	0,41 kg	from stock
15	R 15	0,44 kg	from stock
16	R 16	0,47 kg	from stock