



H8025

Solid, manually operated 3-Way Stainless Steel ball valve with L or T-bore and ISO Top for direct mounting actuator

SIZE

DN08 (1/4") to DN50 (2.1/2")

CONNECTION

- 2-Sided female thread according to DIN 2999, DIN 259
- Mounting flange according to ISO 5211

NOMINAL PRESSURE

Maximum PN63

Druk Temperatuur diagram

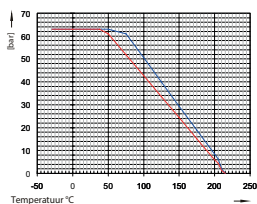

TEMPERATURE RANGE

From -25° to +180°C

MATERIALS

Body: stainless steel DIN 1.4408 (CF8M)
 Ball: stainless steel AISI 316
 Ball seal: PTFE 15% glass fiber reinforced
 Shaft: Stainless steel AISI 316
 Shaft sealing: PTFE 15% glass fiber reinforced
 O-ring: FPM
 Packed gland PTFE
 Lever: RVS AISI 304

FLOW DIRECTION

Random

MOUNTING POSITION

See mounting reference for industrial valves.

MEDIUM

Neutral gases and liquids. For applications with aggressive media consult resistance table. Certain media may increase the torque.

OPERATION (Standard)



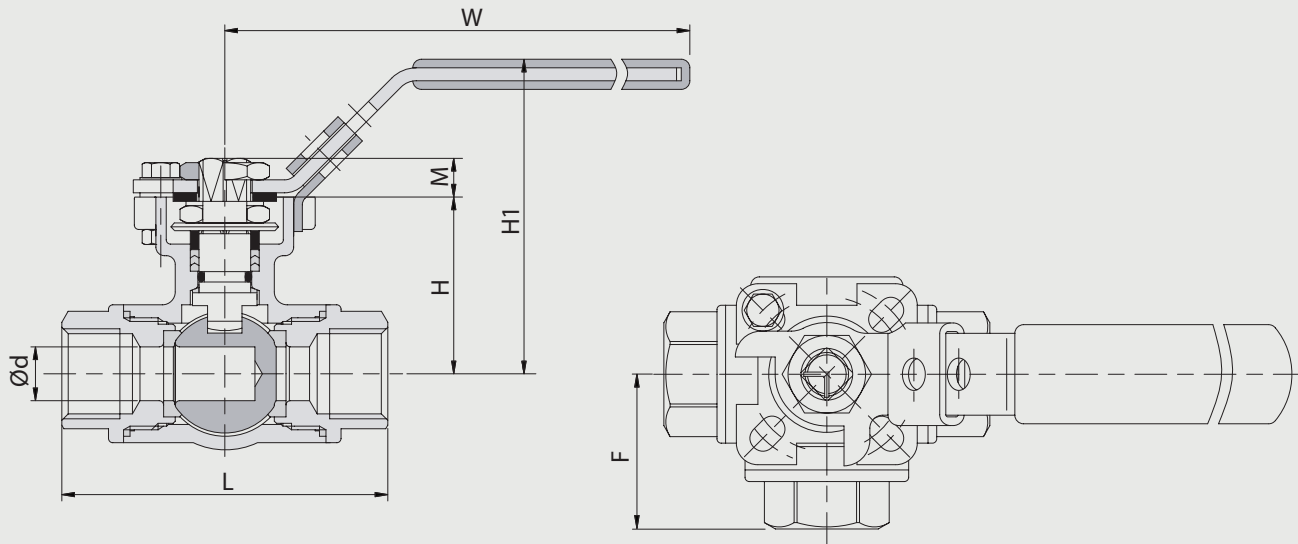

With Lever (secure with lock) or bare shaft

SPECIAL FEATURES

Shaft: Blow-out proof
 Anti-static construction



Boring en schakelbeeld dubbelwerkend

Boring	T	L
90°		
0°		
	T1 = 04	T2 = 05
	T3 = 06	L4 = 03

Ball Valve 3-way L-bore with pipe threads, ISO Top and lever

Nominal[mm] connection[mm]		max. press. [bar]	M(1) +30% [Nm]	Flange	Square	Kv [m ³ /h]	Dimension [mm] and weight [kg]								Order Code
DN	Rp	PN					ød	L	H	H1	W	M	F	Weight	
8	G1/4	63	7	F03/F4	9	11	9,5	75	37	66	130	8	37	0,700	3H80250305
10	G3/8	63	7	F03/F4	9	11	11	75	37	66	130	8	37	0,670	3H80250310
12	G1/2	63	7	F03/F4	9	13	12	75	37	66	130	8	37	0,630	3H80250315
15	G3/4	63	12	F04/F05	11	15	15	85	41	72	161	12	42	0,950	3H80250320
20	G1	63	16	F04/F05	11	31	20	100	47	77	161	12	50	1,400	3H80250325
25	G1.1/4	63	20	F05/F07	14	39	25	122	56	92	203	12	61	2,900	3H80250330
32	G1.1/2	63	30	F05/F07	14	62	32	131	60	96	203	12	65	3,600	3H80250335
40	G2	63	43	F05/F07	14	103	40	158	71	107	203	12	79	6,250	3H80250340
50	G2.1/2	63	43	F07/F10	17	205	49	178	95	135	254	14	89	8,950	3H80250345

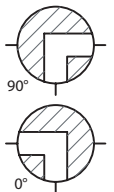

H8025

Ball Valve 3-way T-bore with pipe threads, ISO Top and lever

Nominal[mm] connection[mm]		max. press. [bar]	M(1) +30% [Nm]	Flange	Square	Kv [m3/h]	Dimension [mm] and weight [kg]								Order Code
DN	Rp	PN					ød	L	H	H1	W	M	F	Weight	
8	G1/4	63	7	F03/F4	9	11	9,5	75	37	66	130	8	37	0,700	3H80250405
10	G3/8	63	7	F03/F4	9	11	11	75	37	66	130	8	37	0,670	3H80250410
12	G1/2	63	7	F03/F4	9	13	12	75	37	66	130	8	37	0,630	3H80250415
15	G3/4	63	12	F04/F05	11	15	15	85	41	72	161	12	42	0,950	3H80250420
20	G1	63	16	F04/F05	11	31	20	100	47	77	161	12	50	1,400	3H80250425
25	G1.1/4	63	20	F05/F07	14	39	25	122	56	92	203	12	61	2,900	3H80250430
32	G1.1/2	63	30	F05/F07	14	62	32	131	60	96	203	12	65	3,600	3H80250435
40	G2	63	43	F05/F07	14	103	40	158	71	107	203	12	79	6,250	3H80250440
50	G2.1/2	63	43	F07/F10	17	205	49	178	95	135	254	14	89	8,950	3H80250445

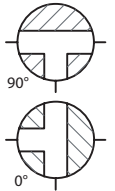

Ball Valve 3-way L-bore with NPT threads, ISO Top and lever

Nominal[mm] connection[mm]		max. press. [bar]	M(1) +30% [Nm]	Flange	Square	Kv [m3/h]	Dimension [mm] and weight [kg]								Order Code
DN	Rp	PN					ød	L	H	H1	W	M	F	Weight	
8	N1/4	63	7	F03/F04	9	11	9,5	75	37	66	130	8	37	0,700	3H8025A405
10	N3/8	63	7	F03/F04	9	11	11	75	37	66	130	8	37	0,670	3H8025A410
12	N1/2	63	7	F03/F04	9	13	12	75	37	66	130	8	37	0,630	3H8025A415
15	N3/4	63	12	F04/F05	11	15	15	85	41	72	161	12	42	0,950	3H8025A420
20	N1	63	16	F04/F05	11	31	20	100	47	77	161	12	50	1,400	3H8025A425
25	N1.1/4	63	20	F05/F07	14	39	25	122	56	92	203	12	61	2,900	3H8025A430
32	N1.1/2	63	30	F05/F07	14	62	32	131	60	96	203	12	65	3,600	3H8025A435
40	N2	63	43	F05/F07	14	103	40	158	71	107	203	12	79	6,250	3H8025A440
50	N2.1/2	63	43	F07/F10	17	205	49	178	95	135	254	14	89	8,950	3H8025A445

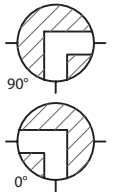

Ball Valve 3-way T-bore with NPT threads, ISO Top and lever

Nominal[mm] connection[mm]		max. press. [bar]	M(1) +30% [Nm]	Flange	Square	Kv [m3/h]	Dimension [mm] and weight [kg]								Order Code
DN	Rp	PN					ød	L	H	H1	W	M	F	Weight	
8	N1/4	63	7	F03/F04	9	11	9,5	75	37	66	130	8	37	0,700	3H8025A805
10	N3/8	63	7	F03/F04	9	11	11	75	37	66	130	8	37	0,670	3H8025A810
12	N1/2	63	7	F03/F04	9	13	12	75	37	66	130	8	37	0,630	3H8025A815
15	N3/4	63	12	F04/F05	11	15	15	85	41	72	161	12	42	0,950	3H8025A820
20	N1	63	16	F04/F05	11	31	20	100	47	77	161	12	50	1,400	3H8025A825
25	N1.1/4	63	20	F05/F07	14	39	25	122	56	92	203	12	61	2,900	3H8025A830
32	N1.1/2	63	30	F05/F07	14	62	32	131	60	96	203	12	65	3,600	3H8025A835
40	N2	63	43	F05/F07	14	103	40	158	71	107	203	12	79	6,250	3H8025A840
50	N2.1/2	63	43	F07/F10	17	205	49	178	95	135	254	14	89	8,950	3H8025A845

